

Freeflow

Design Gordon Guillaumier - 2009

WMO

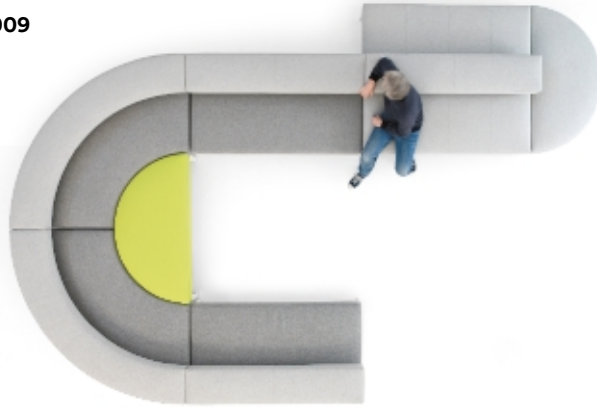

' vol. 1 SOFAS AND SEATING SYSTEMS

SEATING ELEMENTS

Seat in flame-retardant polyurethane foam in varied densities and polyester fiberfill on wood frame.
Back in injected flame-retardant polyurethane foam and polyester fiberfill over internal wood frame.
Base is steel with powder coat finish. Feet are triangular tubular aluminum with powder coat finish.
Levelling glides are polypropylene.

Freeflow collection covers are not removable.

NOTE:

- drawing composition must accompany order.

' vol. 1 DIVANI E SISTEMI DI SEDUTE

ELEMENTI DI SEDUTA

Sedute in poliuretano espanso ignifugo a densità differenziate e fibra poliestere con struttura interna in legno. Schienali in poliuretano schiumato a freddo ignifugo e fibra poliestere con struttura interna in legno. Basamento in acciaio verniciato a polveri. Piedi in tubo triangolare di alluminio verniciato o cromato. Sottopiedi in polipropilene regolabili in altezza.
La collezione Freeflow non è sfoderabile.

NOTA:

- allegare un disegno per ogni ordine di composizione.



Recommended fabric hangers

Tirille e tessuti consigliati

-Divina 3, Divina Melange 3, Divina MD by Kvadrat
-Hallingdal 65 by Kvadrat
-Tonus 4 by Kvadrat
-Stamskin Top
-Pelle / Leather T

Technical tests - Prove tecniche

EN 1728:2000 clause 6.2.1 level 3 severe
EN 1728:2000 clause 6.2.2 level 3 severe
EN 1728:2000 clause 6.7 level 3 severe
EN 15373:2007 Annex A clause A.2 level 3 severe.

Base colors Colori basi



RAL 9003
traffic white



RAL 9005
black

Feet colors Colori piedi



STEEL
chrome



RAL 9003
traffic white



RAL 9005
black

Straight element

Elemento diritto

480

4 mt. 7,3 m² 1,2 m³ 60 Kg

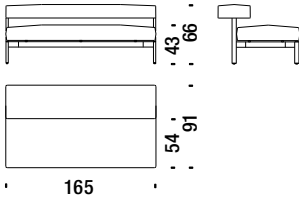

Element closed corner

Elemento curva chiusa

481

6,1 mt. 10,3 m² 2 m³ 79 Kg

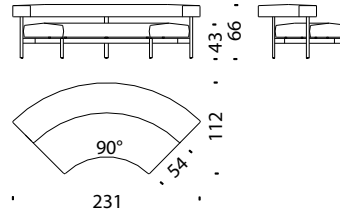

Element open corner

Elemento curva aperta

482

5 mt. 8,3 m² 1,6 m³ 65 Kg

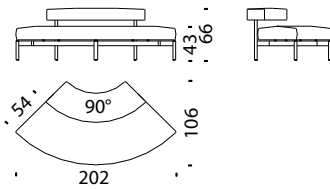

Double face bench

Panca doppia

485

7,7 mt. 13 m² 1,8 m³ 90 Kg

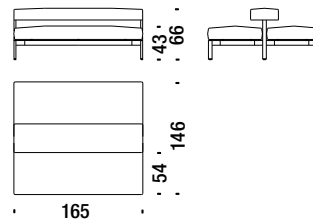

Element Duale left

Elemento Duale sinistro

483

5,3 mt. 9 m² 1,4 m³ 70 Kg

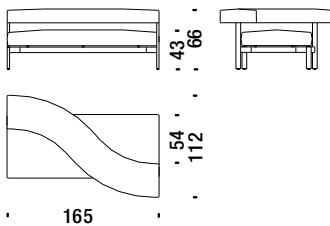

Element Duale right

Elemento Duale destro

484

5,3 mt. 9 m² 1,4 m³ 70 Kg

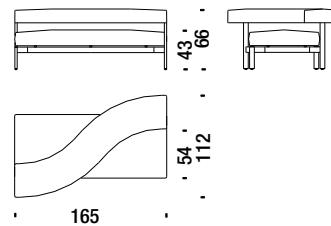

Stool semicircular

Pouf semicircolare

486

2,7 mt. 5 m² 0,5 m³ 30 Kg

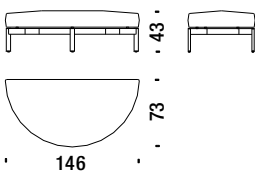

Stool circular

Pouf circolare

487

4 mt. 6,5 m² 1 m³ 40 Kg

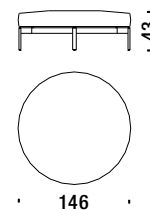

Optional arm

Bracciolo optional

07Q

 5 Kg

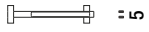

• 48 •