



' vol. 1 **SOFAS AND SEATING SYSTEMS**

SOFAS and SEATING ELEMENTS for COMPOSITIONS

Structure is injected flame-retardant polyurethane foam and polyester fiberfill over internal steel and wood frame.
 Seat cushions are in goose down over polyurethane foam.
 Back, armrest and optional cushions are goose down.
 Feet are in tubular steel with powder coat finish or in varnished ash.

The Josh collection covers are removable.

' vol.1 **SOFAS UND SITZSYSTEME**

SOFAS UND SITZELEMENTE für SITZGRUPPEN

Sitz in unverformbaren Polyurethanschaum, Kaltschaum feuerhemmend und Polyesterwatte mit Innestruktur in Holz und Stahl.
 Sitzkissen in Daune und Polyurethanschaum-Kern.
 Rücken, Armlehnen, Zusatzkissen sind in Daune.
 Füße in pulverbeschichtetem Stahl oder Esche lackiert.
 Das Modell Josh ist komplett abziehbar.



Recommended fabric hangers

Vorgeschlagene Stoffbuegel

- 121-Elastic Fantastic 1 > Elastic 1 Uniform Melange
- 134-Elastic Fantastic 3 > Otto
- 135-Spring Palette > 6, 7 10, 11
- 136-Mini Me > 1 Baby Braid, 2 Mini Husk
- Birds, Leafs, Ikebana

Steel colors Stahl Farben



titanium

Wood colors Holz Farben



ASH grey



ASH graphite



ASH shell



ASH pale tan



ASH tropical wood

2 seater sofa

Sofa 2-Sitzig

002

8,8 mt. ★ 16,8 m² 1,9 m³ 90 Kg

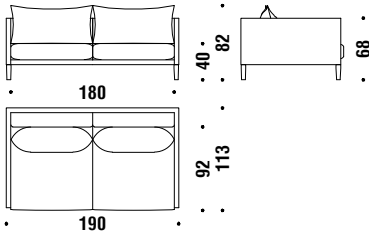

2 seater sofa major

Sofa 2-Sitzig Major

018

9,4 mt. ★ 17,9 m² 2,1 m³ 95 Kg

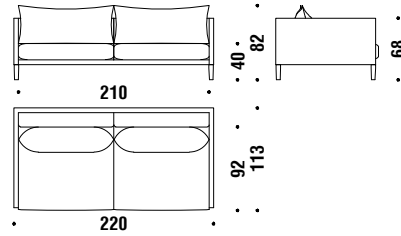

3 seater sofa

Sofa 3-Sitzig

003

9,9 mt. ★ 18,8 m² 2,6 m³ 110 Kg

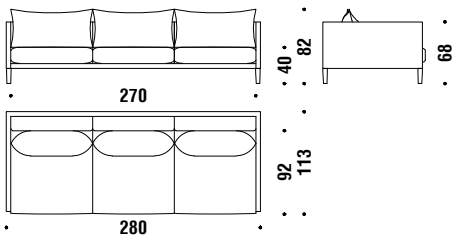

Element left 95

Element links 95

N01

5,9 mt. ★ 11,1 m² 1 m³ 35 Kg

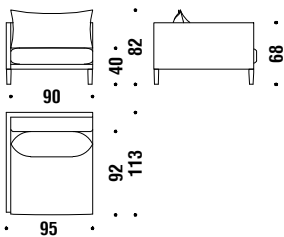

Element right 95

Element rechts 95

N02

5,9 mt. ★ 11,1 m² 1 m³ 35 Kg

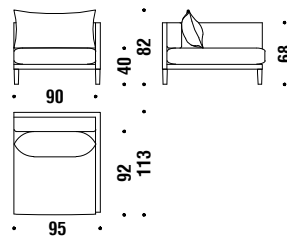

Central element 90

Zentralelement 90

N03

4,4 mt. ★ 8,4 m² 1 m³ 35 Kg

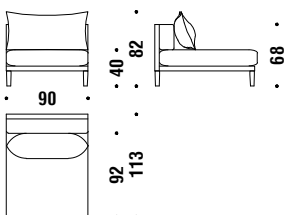

Element left 110

Element links 110

N04

6,1 mt. 11,6 m² 0,7 m³ 40 Kg

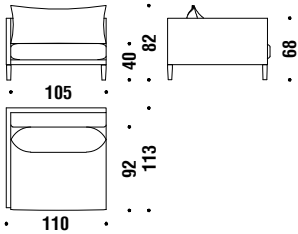

Element right 110

Element rechts 110

N05

6,1 mt. 11,6 m² 0,7 m³ 40 Kg

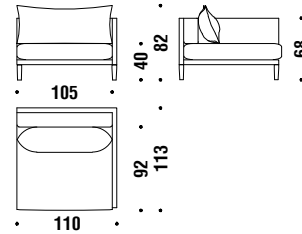

Central element 105

Zentralelement 105

N06

4,8 mt. 9 m² 0,7 m³ 40 Kg

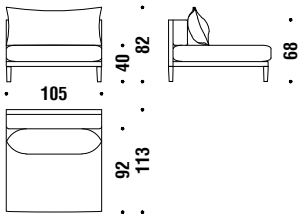

2 seater central element

2-sitz Zentral element

07A

6,4 mt. 12,1 m² 1,9 m³ 65 Kg

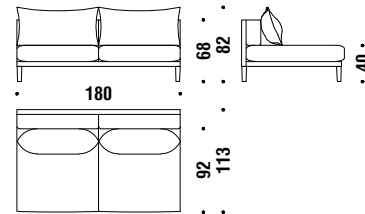

Lateral 2 seat unit left

2-Sitz Element links

023

7,6 mt. 14,4 m² 1,9 m³ 80 Kg

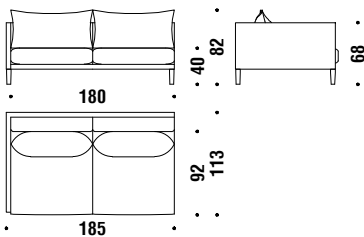

Lateral 2 seat unit right

2-Sitz Element rechts

022

7,6 mt. 14,4 m² 1,9 m³ 80 Kg

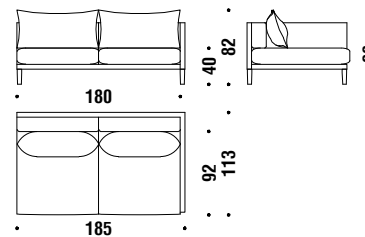

Lateral 2 seat left peninsula

2-Sitz Halbinsel links

0TH

6,4 mt. 12,1 m² 1,9 m³ 80 Kg

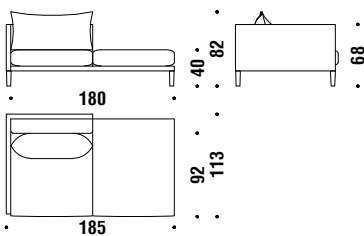

Lateral 2 seat right peninsula

2-Sitz Halbinsel rechts

0TG

6,4 mt. 12,1 m² 1,9 m³ 80 Kg

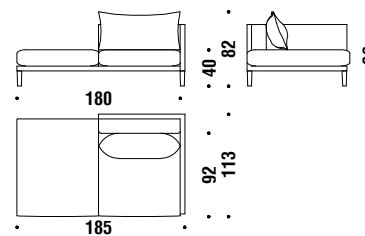

2 seater major central element

2-sitz major Zentral element

OM5

7,1 mt. 13,5 m² 2,1 m³ 80 Kg

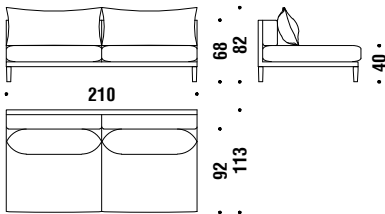

Lateral 2 seat unit major left

2-Sitz Element Major links

037

8,3 mt. 15,8 m² 2,1 m³ 83 Kg

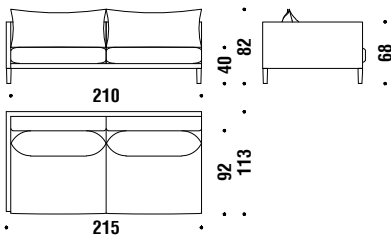

Lateral 2 seat unit major right

2-Sitz Element Major rechts

031

8,3 mt. 15,8 m² 2,1 m³ 83 Kg

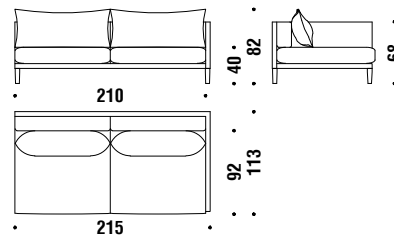

Lateral 3 seat unit left

3-Sitz Element links

033

8,7 mt. 16,5 m² 2,6 m³ 95 Kg

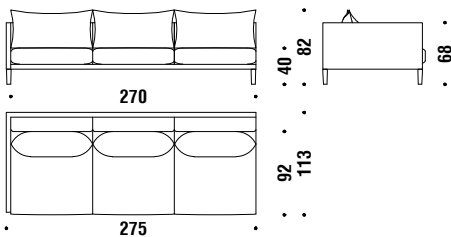

Lateral 3 seat unit right

3-Sitz Element rechts

032

8,7 mt. 16,5 m² 2,6 m³ 95 Kg

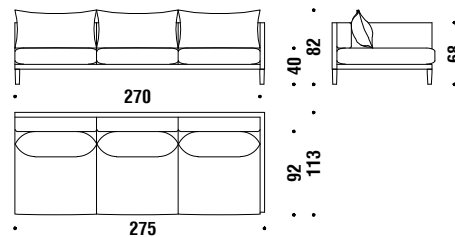

Lateral 2 seat major left peninsula

2-Sitz major Halbinsel links

OTM

7,1 mt. 13,4 m² 2,1 m³ 70 Kg

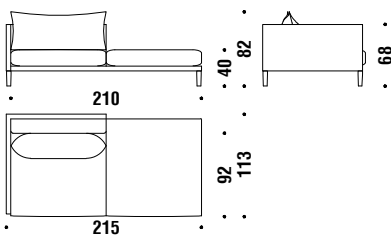

Lateral 2 seat major right peninsula

2-Sitz major Halbinsel rechts

OTL

7,1 mt. 13,4 m² 2,1 m³ 70 Kg

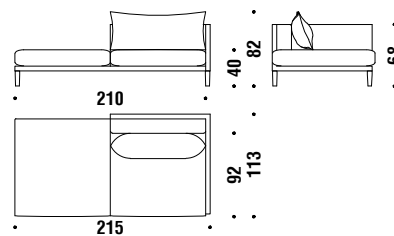

Chaise Longue left 95x160

Chaise Longue links 95x160

OD4

7,2 mt. ★ 13,7 m² 1,4 m³ 65 Kg

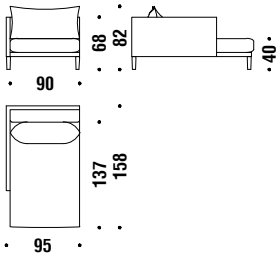

Chaise Longue right 95x160

Chaise Longue rechts 95x160

OD3

7,2 mt. ★ 13,7 m² 1,4 m³ 65 Kg

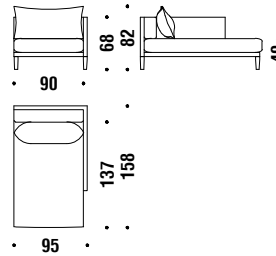

Chaise Longue left 110x190

Chaise Longue links 110x190

OLQ

7,6 mt. ★ 14,4 m² 1,9 m³ 85 Kg

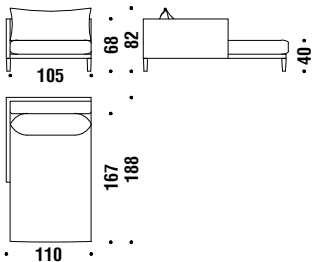

Chaise Longue right 110x190

Chaise Longue rechts 110x190

OLP

7,6 mt. ★ 14,4 m² 1,9 m³ 85 Kg

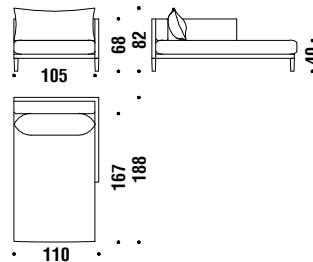

Stool 105x105

Hocker 105x105

775

8,3 mt. ★ 15,8 m² 0,7 m³ 35 Kg

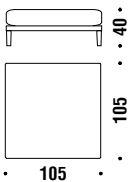

Stool 130x130

Hocker 130x130

987

8,8 mt. ★ 16,8 m² 0,9 m³ 55 Kg

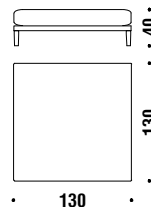

Stool 160x160

Hocker 160x160

988

9,4 mt. ★ 17,8 m² 1,5 m³ 75 Kg

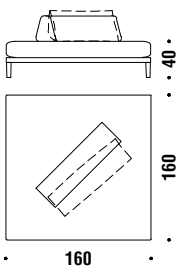

Composition A12

Zusammenstellung A12

A12

15,2 mt. 28,8 m² 3,8 m³ 160 Kg

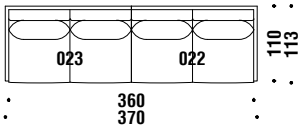

Composition B1 right or B1 left

Zusammenstellung B1 rechts oder B1 links

B01

14,8 mt. 28,1 m² 3,3 m³ 145 Kg

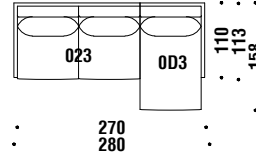

Composition B20R or B20L

Zusammenstellung B20R oder B20L

B20

15,2 mt. 28,8 m² 3,8 m³ 165 Kg

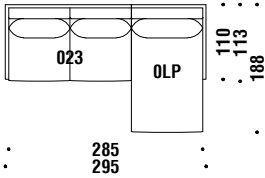

Composition B right or B left

Zusammenstellung B rechts oder B links

B00

15,5 mt. 29,5 m² 3,5 m³ 148 Kg

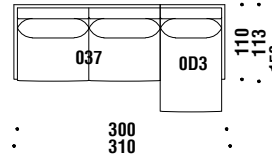

Composition B80R or B80L

Zusammenstellung B80R oder B80L

B80

15,9 mt. 30,2 m² 4 m³ 160 Kg

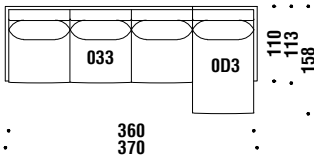

Composition B50R or B50L

Zusammenstellung B50R oder B50L

B50

15,9 mt. 30,2 m² 4 m³ 168 Kg

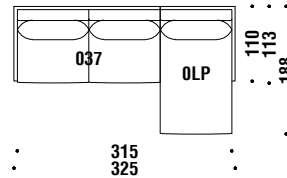

Composition B10R or B10L

Zusammenstellung B10R oder B10L

B10

17 mt. 32,2 m² 3,4 m³ 155 Kg

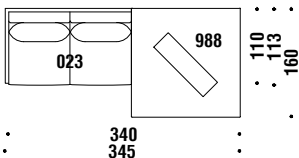

Composition B40R or B40L

Zusammenstellung B40R oder B40L

B40

17,7 mt. 33,6 m² 3,6 m³ 158 Kg

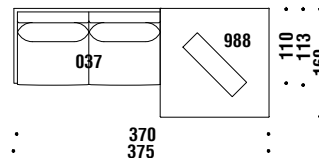

Composition B60R or B60L

Zusammenstellung B60R oder B60L

B60

24,7 mt. ★ 47 m² 4,9 m³ 218 Kg

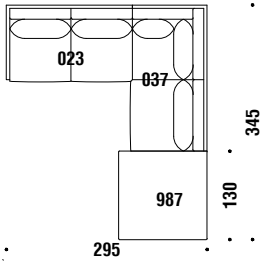

Composition B30R or B30L

Zusammenstellung B30R oder B30L

B30

33,1 mt. ★ 62,9 m² 7,8 m³ 321 Kg

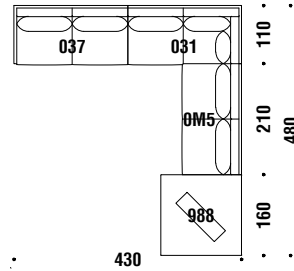

Composition B70R or B70L

Zusammenstellung B70R oder B70L

B70

33,2 mt. ★ 63,2 m² 7 m³ 284 Kg

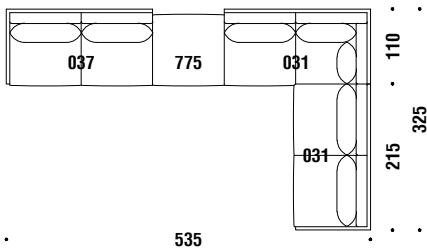

Cushion for stool

Kissen Hocker

05N

1,7 mt. ★ 3,2 m² 7 Kg

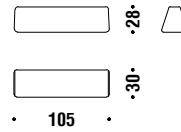

Cushion 60x60

Kissen 60x60

AG0081

0,7 mt. ★ 0,8 m²



Back cushion 105

Rücken Kissen 105

GE00K3

1,2 mt. ★ 2,3 m² 3 Kg

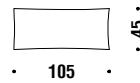

Cushion

Kissen

S31080

