

# Josephine

Design Gordon Guillaumier - 2017

JPO



## SOFAS and SEATING ELEMENTS

Seats in polyurethane foam with differentiated density, sides, and backs in cold injected polyurethane and polyester fiber with an internal wooden structure. As standard, polyurethane complies with CAL TB 117 without flame retardants; the fire retardant version BS 5852, crib 5 is available with an 8% surcharge. Feet in painted ash or lacquered beech. Glides in polyethylene.

The Josephine collection covers are not removable.

## NOTE:

- Recommended fabrics: check out [www.moroso.it/productname](http://www.moroso.it/productname) --> "Configure your product" or [monet.moroso.it](http://monet.moroso.it).

## DIVANI ed ELEMENTI DI SEDUTA

Sedute in poliuretano espanso a densità differenziata, fianchi e schiene in poliuretano schiumato a freddo e fibra poliestere con struttura interna in legno. Di serie, poliuretano conforme a CAL TB 117 privo di ritardanti di fiamma; disponibile la versione ignifuga BS 5852, crib 5 con sovrapprezzo dell'8%. Piedi in frassino verniciato o faggio laccato. Sottopiedi in polietilene. La collezione Josephine non è sfoderabile.

## NOTA:

- Tessuti consigliati: consulta [www.moroso.it/nomeprodotto](http://www.moroso.it/nomeprodotto) --> "Configura il tuo prodotto" oppure [monet.moroso.it](http://monet.moroso.it).

## Base colors Colori basi



NATURAL  
ash



TROPICAL  
WOOD  
ash



HIGH GLOSS  
BLACK  
beech

## 2 seater sofa

### Divano 2 posti

002

5 mt. ★ 10 m<sup>2</sup> ▢ 0,9 m<sup>3</sup> 50 Kg

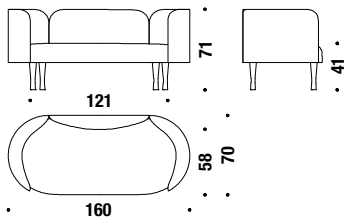

## 2 seater sofa major

### Divano 2 posti major

018

6 mt. ★ 11,4 m<sup>2</sup> ▢ 1,1 m<sup>3</sup> 55 Kg

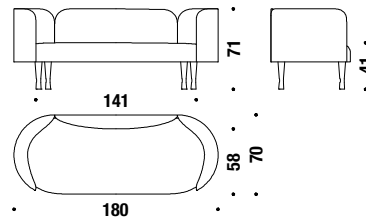

## 3 seater sofa

### Divano 3 posti

003

6,6 mt. ★ 12,6 m<sup>2</sup> ▢ 1,5 m<sup>3</sup> 65 Kg

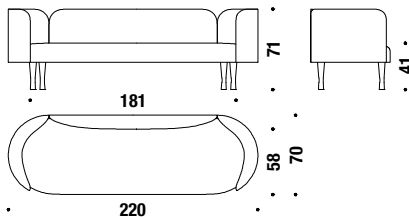

## Bench 174

### Panca da 174

0TF

2 mt. ★ 3,8 m<sup>2</sup> ▢ 1,1 m<sup>3</sup> 50 Kg

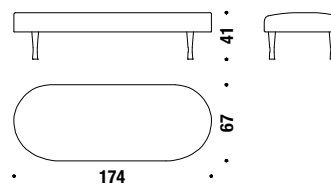

## Bench 154

### Panca 154

0TE

1,8 mt. ★ 3,4 m<sup>2</sup> ▢ 0,9 m<sup>3</sup> 45 Kg

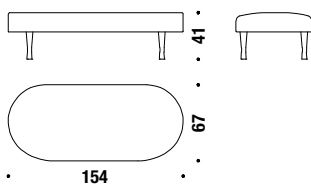

## Vis à vis 180

### Vis à vis 180

0TW

5,1 mt. ★ 9,7 m<sup>2</sup> ▢ 1,1 m<sup>3</sup> 60 Kg

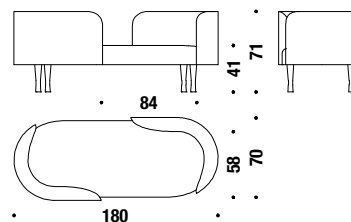

## Vis à vis 160

### Vis à vis 160

0TV

4,8 mt. ★ 9,2 m<sup>2</sup> ▢ 0,9 m<sup>3</sup> 50 Kg

