

' vol. 1 SOFAS AND SEATING SYSTEMS

SEATING ELEMENTS

Seat in stress-resistant flame-retardant polyurethane foam in varied densities and polyester fiberfill on wood frame. Back in injected flame-retardant polyurethane foam and polyester fiberfill over internal wood frame. Base is steel with powder coat finish. Feet are triangular tubular aluminum with powder coat finish. Levelling glides are polypropylene.

Freeflow collection covers are not removable.

NOTE:

- drawing composition must accompany order.

' vol. 1 DIVANI E SISTEMI DI SEDUTE

ELEMENTI DI SEDUTA

Seduta in poliuretano espanso ignifugo indeformabile a densità differenziate e fibra poliestere con struttura interna in legno. Schienale in espanso schiumato a freddo ignifugo e fibra poliestere con struttura interna in legno. Basamento in acciaio verniciato a polveri. Piedi in tubo triangolare di alluminio verniciato o cromato. Sottopiedi in polipropilene regolabili in altezza.

La collezione Freeflow non è sfoderabile.

NOTA:

- allegare un disegno per ogni ordine di composizione.

Design Gordon Guillaumier - 2009



Recommended fabric hangers

Tirelle e tessuti consigliati

110-Kvadrat x Moroso n° 1
-Divina
-Tonus
-Hallingdal
-Extrema
-Stamskin Top

-Pelle / Leather T
-Pelle / Leather Z

Technical tests - Prove tecniche

EN 1728:2000 clause 6.2.1 level 3 severe
EN 1728:2000 clause 6.2.2 level 3 severe
EN 1728:2000 clause 6.7 level 3 severe
EN 15373:2007 Annex A clause A.2 level 3 severe.

Feet colors - Colori piedi



Base colors - Colori basi

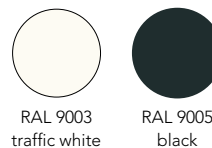



Elements

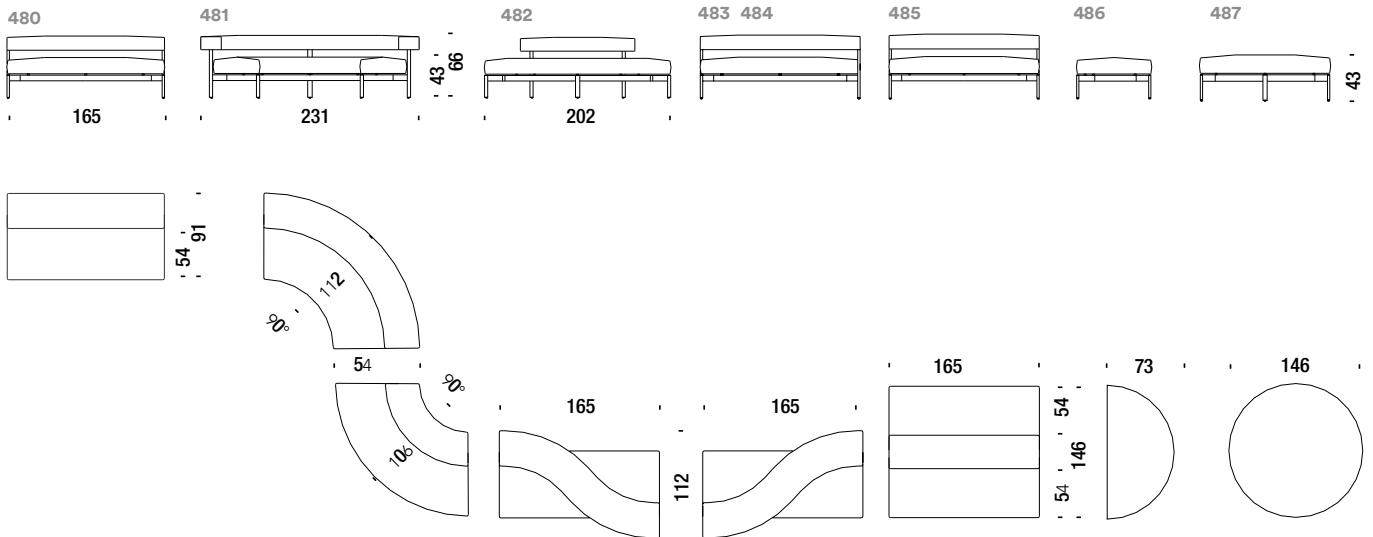

Straight element

Elemento diritto

480

4 mt. ★ 7,3 m² 1,2 m³ 60 Kg

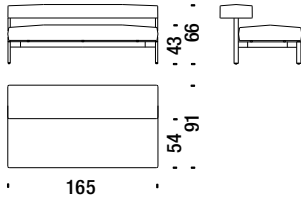

€

H _____

Q _____

S _____

W _____

Y _____

T _____

Z _____

Element closed corner

Elemento curva chiusa

481

6,1 mt. ★ 10,3 m² 2 m³ 79 Kg

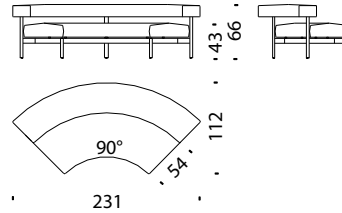

€

H _____

Q _____

S _____

W _____

Y _____

T _____

Z _____

Element open corner

Elemento curva aperta

482

5 mt. ★ 8,3 m² 1,6 m³ 65 Kg

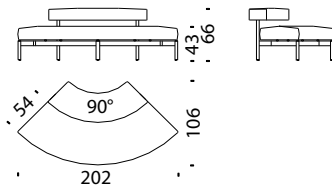

€

H _____

Q _____

S _____

W _____

Y _____

T _____

Z _____

Double face bench

Panca doppia

485

7,7 mt. ★ 13 m² 1,8 m³ 90 Kg

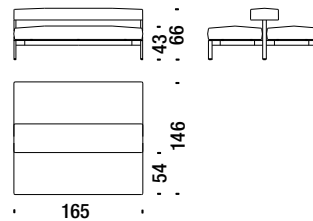

€

H _____

Q _____

S _____

W _____

Y _____

T _____

Z _____

Element Duale left

Elemento Duale sinistro

483

5,3 mt. ★ 9 m² 1,4 m³ 70 Kg

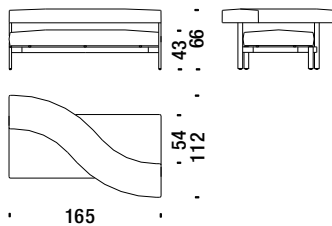

€

H _____

Q _____

S _____

W _____

Y _____

T _____

Z _____

Element Duale right

Elemento Duale destro

484

5,3 mt. ★ 9 m² 1,4 m³ 70 Kg

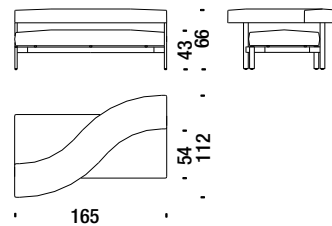

€

H _____

Q _____

S _____

W _____

Y _____

T _____

Z _____

Stool semicircular

Pouf semicircolare

486

2,7 mt. ★ 5 m² 0,5 m³ 30 Kg

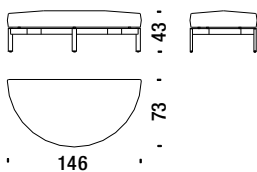

€

H _____

Q _____

S _____

W _____

Y _____

T _____

Z _____

Stool circular

Pouf circolare

487

4 mt. ★ 6,5 m² 1 m³ 40 Kg

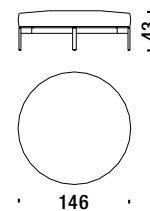

€

H _____

Q _____

S _____

W _____

Y _____

T _____

Z _____

Optional arm

Bracciolo optional

07Q

 5 Kg

€



· 48 ·

H _____

Q _____

S _____

W _____

Y _____

T _____

Z _____